



THE  
OAKS  
ALNE



## The Oaks, Alne, York Prices From £400,000

\*\*\*\* COMING SOON - EXCLUSIVE RURAL DEVELOPMENT \*\*\*\*

Stunning new build barn conversions set just outside the ever popular village of Alne, including 3 single storey dwellings with an additional detached bungalow.

The development has been imaginatively designed throughout creating ideal accommodation for couples, small families and retirees, set within generous gardens with a high specification finish.



# THE OAKS

ALNE

## Foreword

The Oaks is a spacious and secluded development on the edge of the sought after location of Alne, featuring four single storey homes, architecturally designed with a high specification finish. Features include underfloor heating, bifold doors, off street parking and very unique external features and materials.

Plots 2 - 4 are represented by a row of 3 bedroom bungalows with open plan living set with generous gardens. Each of the 3 units feature an ensuite master bedroom in addition to a house bathroom and fully fitted kitchen with bifold doors running out onto the south facing rear garden.

The attention to detail throughout the development is first class and an on site inspection is strongly recommended.

COMPLETION ANTICIPATED FOR SEPTEMBER 2026.



THE  
OAKS

ALNE

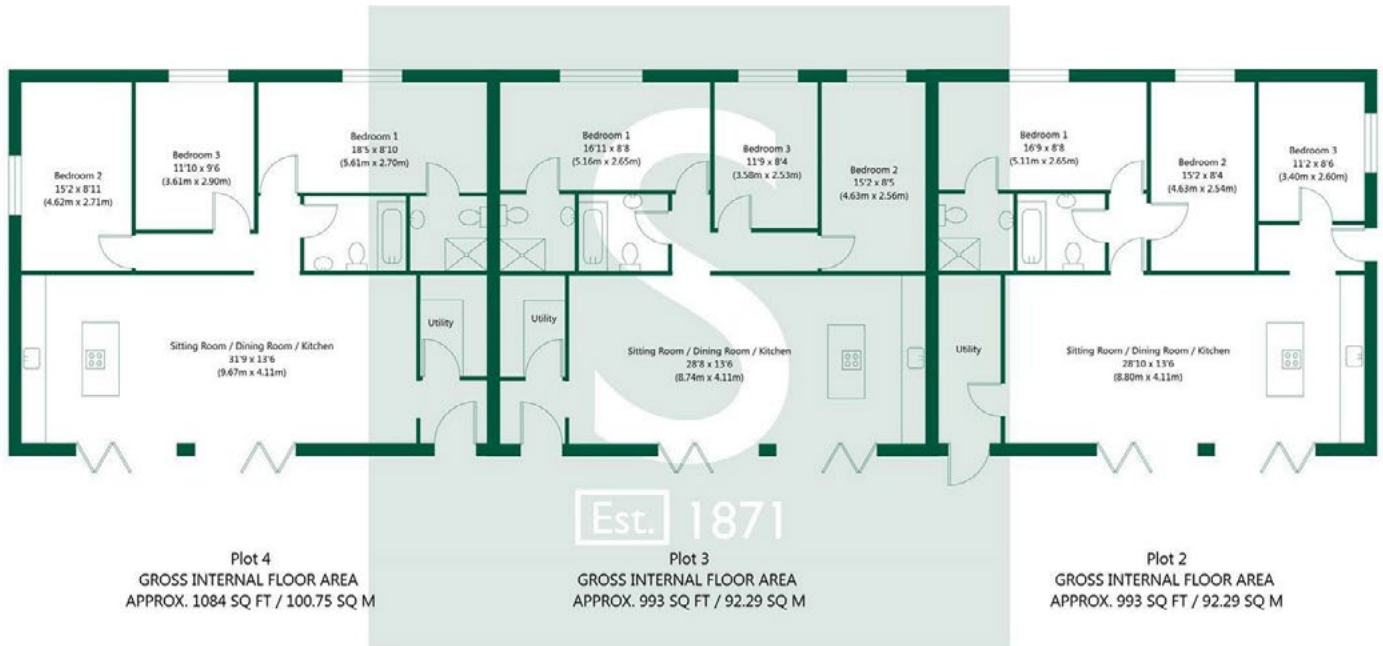

NOT TO SCALE - FOR ILLUSTRATIVE PURPOSES ONLY  
 APPROXIMATE GROSS INTERNAL FLOOR AREA 3070 SQ FT / 285.33 SQ M  
 All measurements and fixtures including doors and windows are approximate and should be independently verified.



**Stephensons**

York	01904 625533
Knaresborough	01423 867700
Selby	01757 706707
Boroughbridge	01423 324324
Easingwold	01347 821145
York Auction Centre	01904 489731
Haxby	01904 809900

**Partners**

- J F Stephenson MA (cantab) FRICS FAAV
- I E Reynolds BSc (Est Man) FRICS
- R E F Stephenson BSc (Est Man) MRICS FAAV
- N J C Kay BA (Hons) pg dip MRICS
- O J Newby MNAEA
- J E Reynolds BA (Hons) MRICS
- R L Cordingley BSc FRICS FAAV
- J C Drewniak BA (Hons)

**Associates**

N Lawrence

